

Saddle Tap

Detail

- Press-On Saddle Tap
- Galvanized Steel (ASTM A653 and A924)
- G-60 Galvanized Coating (ASTM A653 and ASTM 90)
- G-90 available upon request
- Available in Specialty Metals:
 - Aluminum (ASTM B209 Alloy 3003 Temper H14)
 - 304 Stainless Steel (ASTM A480 2B Finish)
- Pressure Rating: Designed per SMACNA Third Edition 2005 Section 4.8 Figure 4-6 Brand Connections
- Dimensional Tolerance: $\pm 1/4"$
- Sealed joints
- Non-damper taps are supplied with 3/8" knock-outs



Profile

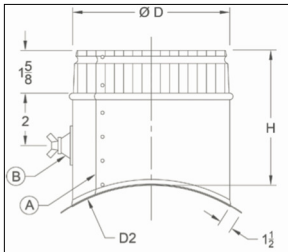

Saddle Tap	Option	Collar Diameter	Pipe Diameter	Material	Gauge	G 90	Option	Option
ST	S2 2" Stand off option	6	10	GA - Galv. S4 - SS304 AL - AL	26,24 26 32	90	DS= Damper	38 = 3/8" Sure-Loc Hardware

Item Code Example: ST610GA26 = Saddle Tap 6" Collar on 10" Round, Galv., 26 ga.

Packaging

Collar Dia (D)	Pipe Dia (D2)	H	Carton Qty
4"	6" 8"-10"	5 3/4"	30
5"	7"-9" 10"-12"	5 3/4"	25
6"	6" 7"-8" 8"-10", 12"-14" 16"-18" 20"-22"	5 3/4"	20
7"	10"-12" 14"-16"	5 3/4"	20
8"	8" 10"-12" 14"-16" 18"-20" 22"-24"	5 3/4"	20
10"	10" 12"-14" 16"-18" 20"-22"	5 3/4"	10

Collar Dia (D)	Pipe Dia (D2)	H	Carton Qty
12"	12" 14"-16" 18"-20" 22"-24"	7 3/4"	10
14"	14" 16"-18" 20"-22" 24"-26"	7 3/4"	5
16"	16" 18"-20" 22"-24"	7 3/4"	5
18"	18" 20"-22" 24"	7 3/4"	5
20"	20" 22"-24"	7 3/4"	5

Available in 26 and 24 Gauge (4" on 6" in 26 ga only)

CONTACT

Office: 888.973.7600

1100 Ashwood Drive
Suite 1102
Canonsburg, PA 15317

www.clward.com